

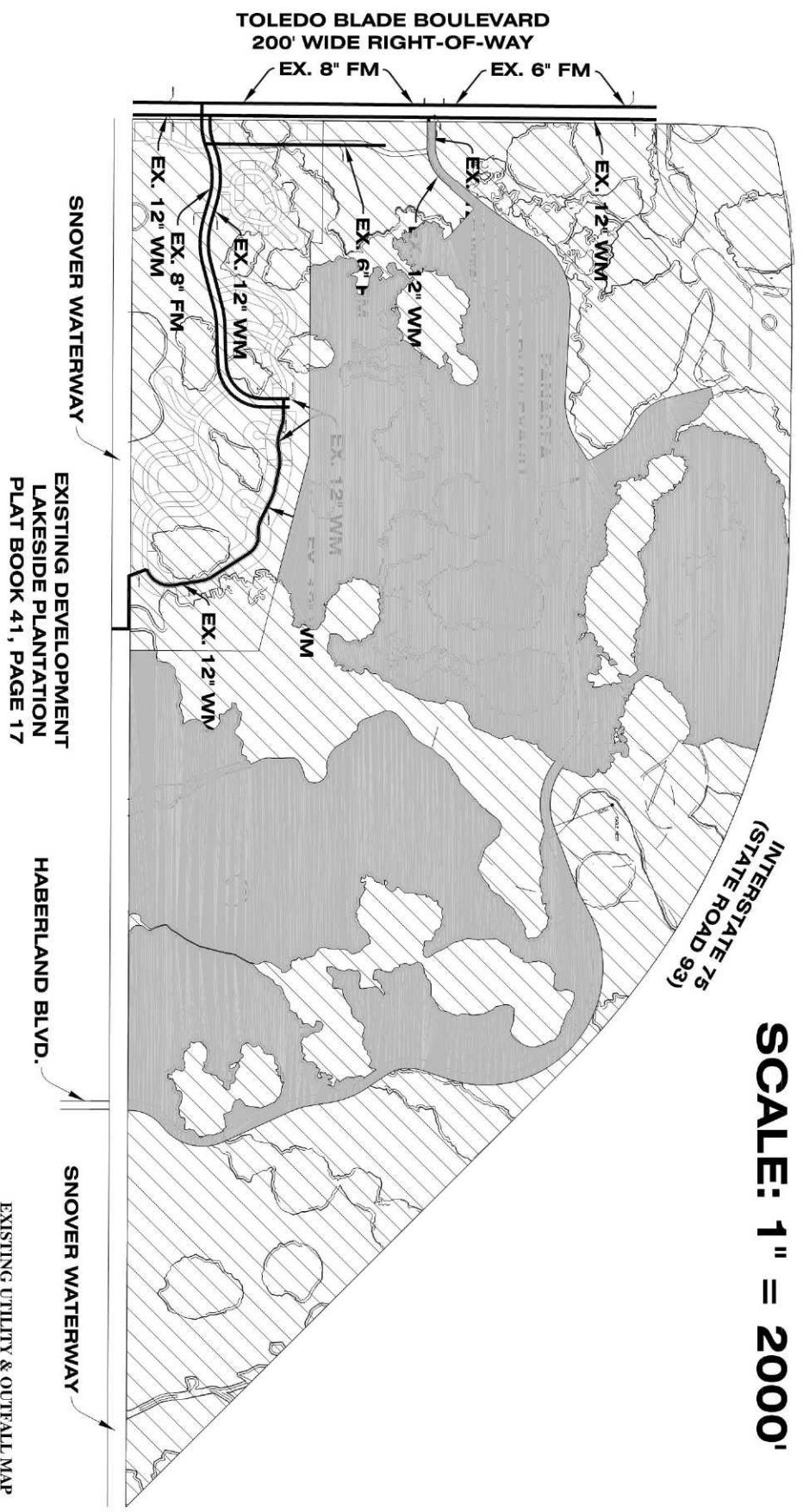

SCALE: 1" = 2000'

**INTERSTATE 75
(STATE ROAD 93)**



**EXISTING UTILITY & OUTFALL MAP
PANACEA BOULEVARD**

Myland, Inc.
WOODLANDS, CDD
8441 COOPER CREEK BOULEVARD
UNIVERSITY PARK, FLORIDA
Phone: (941) 359-8908

SARASOTA COUNTY, FLORIDA

LEGEND

INCLUDED

EXCLUDED INTERIOR PARCELS

**EXISTING DEVELOPMENT
LAKESIDE PLANTATION
PLAT BOOK 41, PAGE 17**

HABERLAND BLVD.

SNOVER WATERWAY

**TOLEDO BLADE BOULEVARD
200' WIDE RIGHT-OF-WAY**

EX. 8" FM EX. 6" FM

EX. 12" WM EX. 6" P
EX. 12" WM EX. 12" WM
EX. 12" WM EX. 12" WM
EX. 12" WM

REVISIONS	DESCRIPTION	DATE

PREPARED BY: **HEIDT & ASSOCIATES, Inc.**
Tampa ♦ Fort Myers

Tampa Office
CIVIL ENGINEERING
2212 Swann Avenue
Tampa, Florida 33606
Phone: 813-253-5311
Fax: 813-253-5311

Supervising
ENVIRONMENTAL PERMITTING
LANDSCAPE ARCHITECTURE
Phone: 813-253-2478
Fax: 813-253-2478

DRAWN: MACDOUGALL	CHECKED: CALE
JOB NO.: WDL-FB-002	DATE: 10/31/03
FILE: EXH-EXULT	

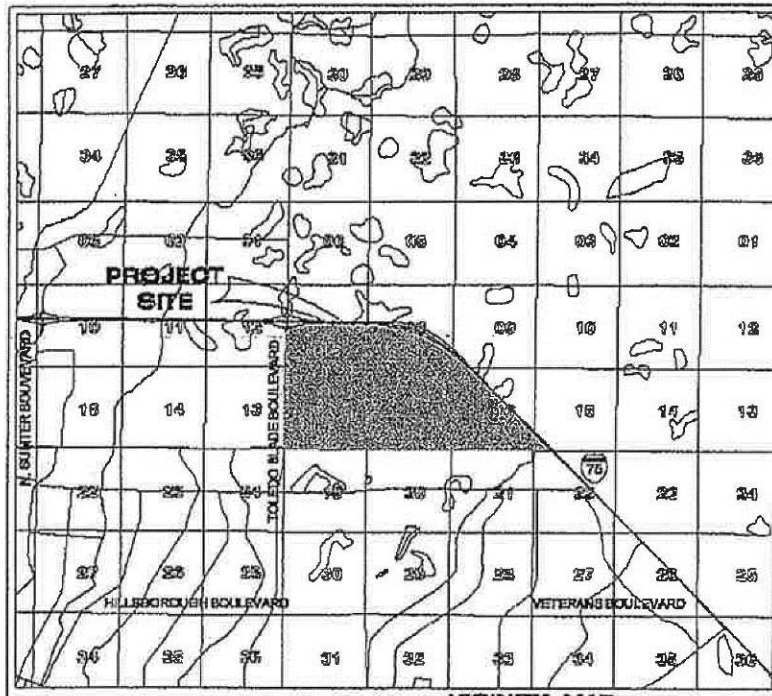

VICINITY MAP

SARASOTA COUNTY, FLORIDA
SECTION 7, TOWNSHIP 26 SOUTH, RANGE 22 EAST

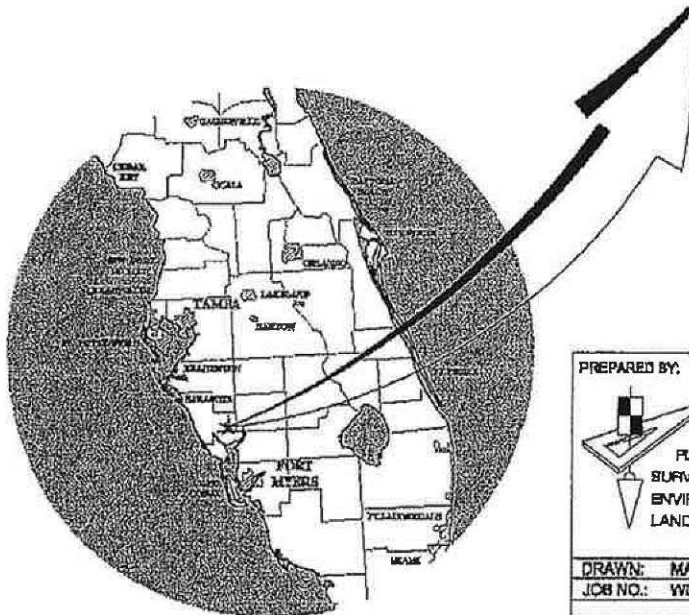

PREPARED BY: **HEIDT & ASSOCIATES, Inc.**
Tampa • Fort Myers

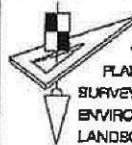

CIVIL ENGINEERING
PLANNING
SURVEYING
ENVIRONMENTAL PERMITTING
LANDSCAPE ARCHITECTURE

Tampa Office
2212 Swann Avenue
Tampa, Florida 33608
Phone: 813-288-6311
Pinellas: 727-442-8898
Pasco: 727-642-2401
FAX: 813-253-2478

DRAWN: MACDOUGALL	CHECKED: CALE
JOB NO.: WDL-PB-002	DATE: 9/23/03
	FILE: CV

SHEET 1 OF 1



Prepared For:
THE WOODLANDS CDD
 8210 Lakewood Ranch Boulevard
 Bradenton, Florida 34202
 Phone: 941 328 1111
 FAX: 941 328 1100

THE WOODLANDS

City of North Port, Florida
Master Plan Exhibit

HEIDT & ASSOCIATES, INC.
 1100 S. W. 11th Street
 Suite 100
 Ft. Lauderdale, FL 33304
 Phone: 954.341.1111
 Fax: 954.341.1112